

CECON TBN

CABLE LAY SUPPORT VESSEL

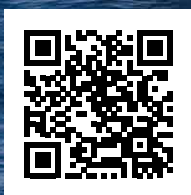



The new built Cecon TBN is a groundbreaking state-of-the-art cable installation vessel which will be delivered from Sefine Shipyard in Turkey Q1 2025. With a battery package for hybrid energy storage and dual fuel generators for Methanol fuel, the vessel has a significant reduction in harmful emissions compared to existing conventional tonnage.

Cecon TBN is prepared for taking more than 2800 ton cable in an underdeck storage tank in addition to Cecons modular on-deck cable storage tank. The vessel is prepared for installation of repeatered and un-repeatered cable systems with Cecons unique over-the-side simultaneous install and trench method.

Cecon TBN is designed as a versatile work platform, allowing the vessel to operate in other segments of the offshore industry when not installing cable, prepared for typical offshore wind services as well as light construction work and cable repair. The vessel has an open deck of 1020 m², a 70 ton 3D AHC crane and SPS accommodation for 100 persons.

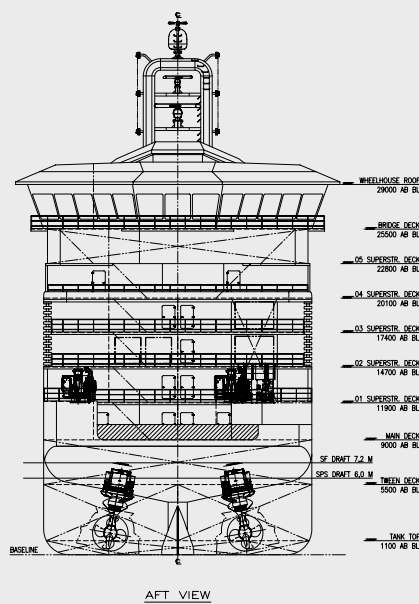
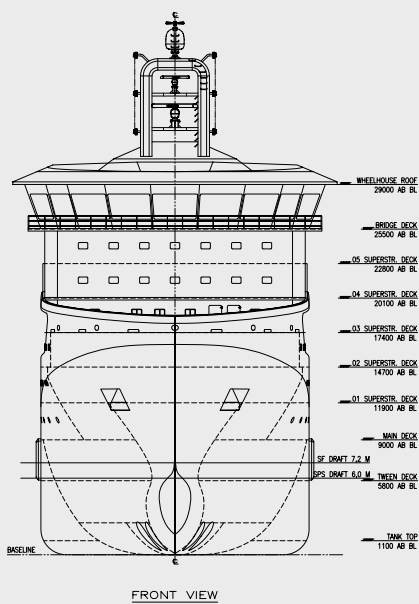
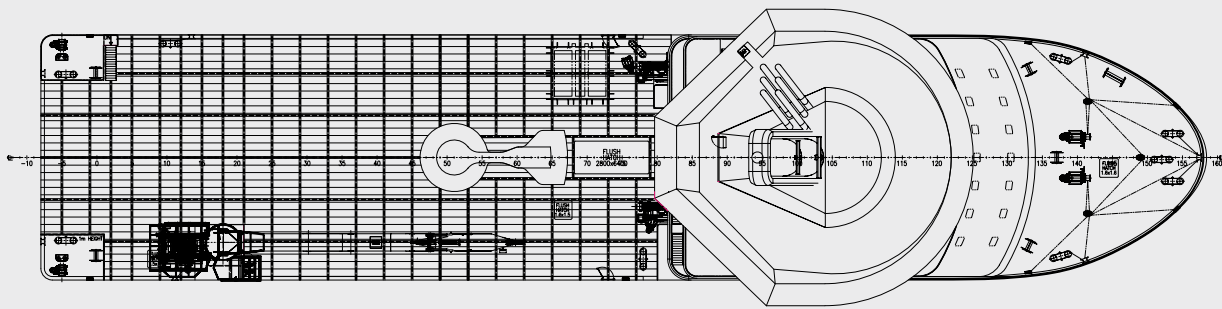
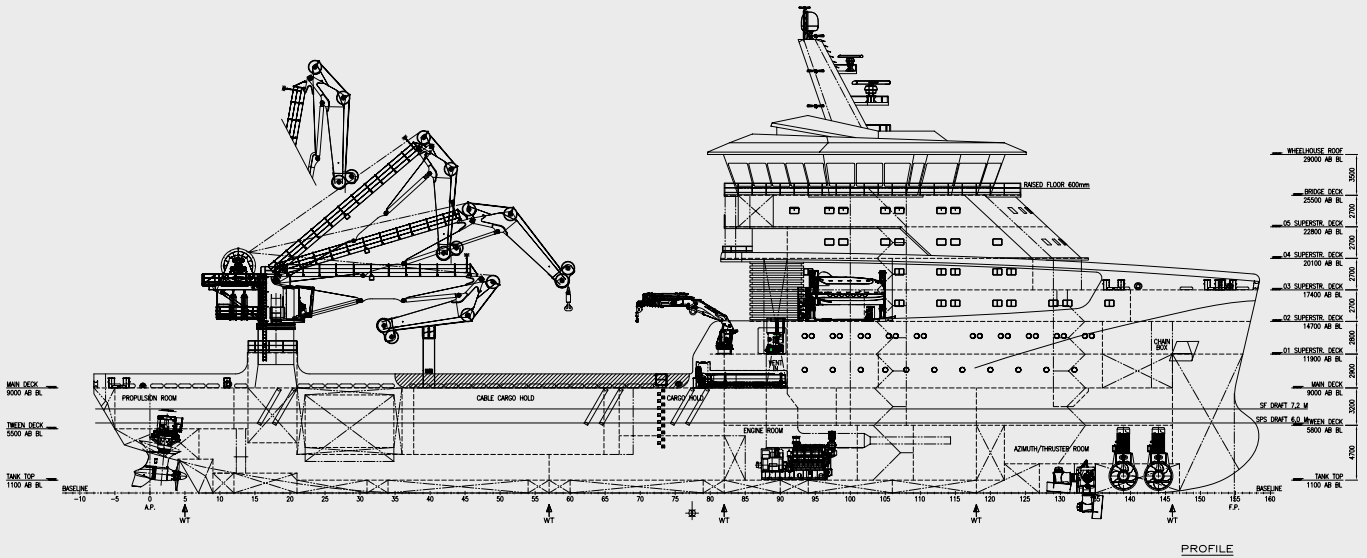

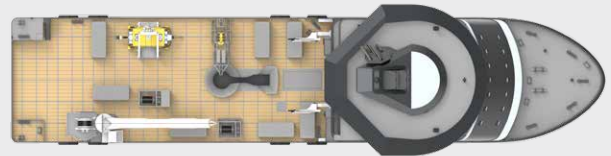

MAIN DIMENSIONS

Length overall	99.90 m
Length between p.p.	89.25 m
Breadth moulded	21.00 m
Depth main deck	9.0 m
Design draft, SPS	6.00 m
Max draft, SF approx	7.50 m
Min draft (Lightship)	4.00 m

CAPACITIES

Cable cargo hold capacity	2800 T
Fuel oil	1200 m ³
Methanol	700 m ³
Freshwater	400 m ³
UREA	105 m ³
Deck capacity	10 T/m ²
Deck load 1 m ab. deck (SPS) stab) app.	-2500 T
Deck load 1 m ab. deck (SF) stab) app.	-3300 T
Deadweight 6.0 m draft	-4000 T
Deadweight max draft	-6000 T

MACHINERY

Methanol genset TIER III	4x1500 kW
Emergency genset	300 kW
Incinerator	
Battery, redundant connection	1x1372 kW with discharge rate 2C

PROPULSION SYSTEM

MAIN PROPULSION SYSTEM:

- 2x Pulling azimuth thrusters
2200 kW each
- FP, Frequency controlled speed

THRUSTERS:

- 2x1100 kW T
Unnel thrusters
- 1x1000 kW swing-up/retractable azimuth

ACCOMODATION

100 persons accommodation SPS
Large and modern galley, mess, day room and conference room
Gym/sauna and wardrobes

CLASSIFICATION

DNV Class + 1A / Cable Lay Support Vessel - SF - E0
Strengthened (dk) - Clean Design / NAUTOSV(A)
COMF V(3) C(3) / DYNPOS AUTR / SPS
Battery Power - LFL FUELLED / ER(SCR, Tier III)
LCS - BIS NIS flag

CARGO PREPARATIONS

Cable cargo hold below main deck
AHC Crane, 70 T (12-30 m reach), Subsea, Topside and 3D compensation
Cargo hold for 20' containers below deck
Deck layout with fixing points for quick mobilisation of cable laying spread
ROV power supply and deck arr
Cranes: 2 x deck cranes
Large deadweight capacity when operating as offshore vessel
SF stability

OPTIONS

Reel drive system for Power Cable
Umbilical and Flexible Flowline installation
Cable repair spread
WROV spread
Boat landing
AHC gangway with direct access from superstructure